

# Hudson Rail Link Schedule

Effective: September 20, 2021

**MONDAY - FRIDAY** (Except Holidays) RIVERDALE—NEW YORK

Effective: September 20, 2021 - until further notice



NO SMOKING ON BOARD BUSES/TRAINS

TO NEW YORK	BUS ROUTE	AM PEAK										OFF-PEAK																				
		C	C	C	C	C	C	C	C	C	C	C	C	C	C	C	C	C	C	C	C	C	C	C	C	C	C	C	C			
		AM	AM	AM	AM	AM	AM	AM	AM	AM	AM	AM	AM	PM	PM	PM	PM	PM	PM	PM	PM	PM	PM	PM	PM	PM	PM	PM	PM			
Riverdale Ave. & 261 St. (east side)		5 40	6 09	6 37	6 57	7 21	7 45	8 10	8 38	8 57	9 30	9 57	10 27	11 09	12 09	1 09	1 36	2 09	2 36	3 09	3 36	4 13	4 42	5 13	5 45	6 16	6 41	7 13	8 13	9 09	10 09	11 09
Broadway & 260 St.		5 42	6 11	6 39	6 59	7 23	7 47	8 12	8 40	8 59	9 32	9 59	10 29	11 11	12 11	1 11	1 38	2 11	2 38	3 11	3 38	4 15	4 44	5 15	5 47	6 18	6 43	7 15	8 15	9 11	10 11	11 11
David Sheridan Plaza		5 43	6 12	6 40	7 00	7 24	7 48	8 13	8 41	9 00	9 33	10 00	10 30	11 12	12 12	1 12	1 39	2 12	2 39	3 12	3 39	4 16	4 45	5 16	5 49	6 19	6 44	7 16	8 16	9 12	10 12	11 12
Mosholu Ave. & Fieldston Rd.		5 44	6 13	6 41	7 01	7 25	7 49	8 14	8 42	9 01	9 34	10 01	10 31	11 13	12 13	1 13	1 40	2 13	2 40	3 13	3 40	4 17	4 46	5 17	5 49	6 20	6 45	7 17	8 17	9 13	10 13	11 13
259 St. & Arlington Ave.		5 46	6 15	6 43	7 03	7 27	7 51	8 16	8 44	9 03	9 36	10 03	10 33	11 15	12 15	1 15	1 42	2 15	2 42	3 15	3 42	4 19	4 48	5 19	5 51	6 22	6 47	7 19	8 19	9 15	10 15	11 15
Riverdale Ave. & 259 St.		5 47	6 16	6 44	7 04	7 28	7 52	8 17	8 45	9 04	9 37	10 04	10 34	11 16	12 16	1 16	1 43	2 16	2 43	3 16	3 43	4 20	4 49	5 20	5 52	6 23	6 48	7 20	8 20	9 16	10 16	11 16
Riverdale Ave. & 256 St.		5 48	6 17	6 45	7 05	7 29	7 53	8 18	8 46	9 05	9 38	10 05	10 35	11 17	12 17	1 17	1 44	2 17	2 44	3 17	3 44	4 21	4 50	5 21	5 53	6 24	6 49	7 21	8 21	9 17	10 17	11 17
Riverdale Ave. & 254 St.		5 49	6 18	6 46	7 06	7 30	7 54	8 19	8 47	9 06	9 39	10 06	10 36	11 18	12 18	1 18	1 45	2 18	2 45	3 18	3 45	4 22	4 51	5 22	5 54	6 25	6 50	7 22	8 22	9 18	10 18	11 18
Riverdale Station		5 54	6 23	6 51	7 11	7 35	7 59	8 24	8 52	9 11	9 44	10 11	10 41	11 23	12 23	1 23	1 50	2 23	2 50	3 23	3 50	4 27	4 56	5 27	5 59	6 30	6 54	7 27	8 27	9 23	10 23	11 23

**Transfer to METRO-NORTH**

Riverdale Station	Lv.	6 00	6 29	6 57	7 17	7 41	8 05	8 30	8 58	9 17	9 50	10 17	10 47	11 29	12 29	1 29	1 56	2 29	2 56	3 29	3 56	4 33	5 02	5 33	6 05	6 36	7 00	7 33	8 33	9 29	10 29	11 29
Grand Central Terminal	Ar.	6 32	7 00	7 32	7 52	8 13	8 38	9 03	9 32	9 51	10 23	10 50	11 20	12 07	1 07	2 07	2 28	3 07	3 28	4 08	4 29	5 08	5 39	6 10	6 42	7 10	7 31	8 07	9 07	10 07	11 07	12 07

TO RIVERDALE	Train #	AM PEAK								OFF-PEAK								PM PEAK						OFF-PEAK								
		705	707	709	711	713	4713	715	717	719	721	725	729	733	737	739	741	4743	747	753	4759	4763	4767	771	775	4777	781	787	4887	791	4891	795
Grand Central Terminal	Lv.	6 21	6 50	7 23	7 45	8 15	8 31	9 00	9 20	9 58	10 20	11 20	12 20	1 20	2 20	2 51	3 21	3 51	4 18	4 49	5 23	5 44	6 06	6 28	6 55	7 28	7 59	9 20	9 54	10 20	10 54	11 20
Riverdale Station	Ar.	6 48	7 17	7 50	8 12	8 44	8 57	9 26	9 48	10 24	10 48	11 48	12 48	1 48	2 48	3 19	3 49	4 19	4 47	5 20	5 50	6 12	6 33	6 57	7 24	7 55	8 28	9 48	10 20	10 48	11 20	11 48

**Transfer to HUDSON RAIL LINK** The Hudson Rail Link will meet all trains listed above. Please check signs in window for specific stops or ask the bus operator for assistance.

FARES										
Effective: April 21, 2019 - Fares subject to change										
To Grand Central Terminal	Monthly Bus/Rail Unilticket	Monthly Rail Only	Monthly Rail plus Unlimited MetroCard	Weekly Bus/Rail Unilticket	Peak ten-trip	Peak One-Way (1)	Off-peak One-Way (1)	Off-peak ten-trip (1)	Senior/Disabled* One-Way	Child 5-11 Family Fare (1)
(1) Rail Fare	\$256.25	\$216.00	\$343.00	\$80.00	\$97.50	\$9.75	\$7.25	\$61.75	\$4.75	\$1.00
Bus Fare		\$2.75 per ride			\$2.75 per ride	\$2.75	\$2.75	\$2.75 per ride	\$1.35	\$0.75

**REFERENCE MARKS**

\* Sr. Citizen/Disabled — 50% Off the One-Way Peak fare. Valid for use on all trains except on weekday trains arriving GCT between 5AM and 10AM. Identification required: Senior Citizen Identification — Medicare card or driver's license; Person with Disability Identification — Medicare card or disabled identification card issued by MTA, Connecticut, or New York City.

(1) Rail Fares displayed are for tickets purchased at a ticket office, ticket machine or on the MTA eTix® app.

Gray shaded areas indicate trains/buses requiring peak fares.

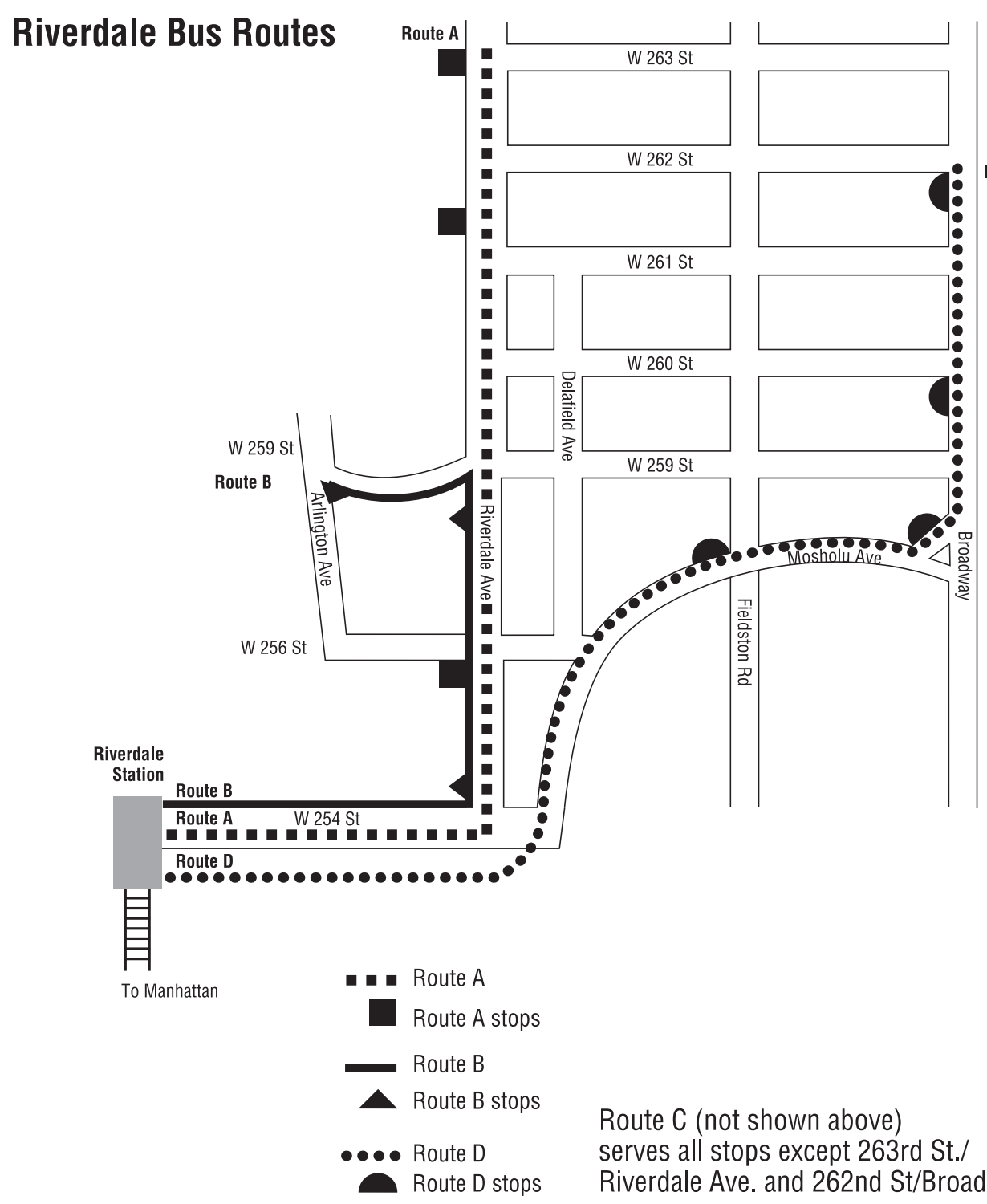

**TELEPHONE INFORMATION**

**General Information and Customer Service:**  
Schedules, Lost & Found, Mail&Ride, Group Sales, Parking, Fares, Bicycle Permits, Comments, Concerns and Commendations, and Senior Citizen/Disabled accessibility.....511  
Deaf/Hard of Hearing - Use your preferred relay service provider or the free 711 relay to reach 511.

**MTA Metro-North Main Office**  
420 Lexington Avenue, NY, NY 10170 .....511  
MTA Inspector General Hot Line ..... 800-MTA-IG4U (800-682-4448)

**Hudson Rail Link Office/Lost & Found.....718-346-9696**

**Other Transit Information**  
New York City Transit Subway & Bus .....511  
Westchester County Bus .....914-813-7777  
Rockland County Bus .....845-364-3333  
Putnam County Bus .....845-878-3480  
Dutchess County Bus .....845-473-8424  
Amtrak .....800-872-7245  
LAZ Parking.....888-682-PARK (888-682-7275)  
NY Waterway.....800-53-FERRY (800-533-3779)

**MTA eTix®**  
Buy your monthly, weekly, ten-trip, one-way, round trip and CityTickets for Metro-North directly from your mobile device using MTA eTix. Download the free App, create your account and enter your credit/debit card information. Don't forget to activate the ticket just before boarding the train! Monthly and weekly Uniltickets are not available for purchase on MTA eTix. Uniltickets can only be purchased at ticket vending machines or ticket offices.

**HOLIDAYS**

Hudson Rail Link service will not operate Saturdays,  
 • Labor Day (9/6)  
 • Thanksgiving Day (11/25)  
 • Christmas Day (observed) (12/24)  
 • New Year's Day (observed) (12/31)  
 • President's Day (2/21/2022)

A special reduced schedule will operate on:  
 • Day after Thanksgiving Day (11/26)  
 • Dr. Martin Luther King, Jr. Day (1/17/2022)

**GRAND CENTRAL NORTH**

**EXITS:** 47th Street and Madison Avenue  
230 Park Avenue (East & West Walks)  
48th Street and Park Avenue

**OPEN:** Monday - Friday: 6:30am - 9:30 pm  
Sat., Sun., & Holidays: Closed

Remember to buy tickets before boarding your train. Tickets purchased on board the train are sold at a higher fare.

MTA Police (212) 878-1001

**EMERGENCY ONLY (888) MTA-911PD**

**Title VI Statement:**  
MTA Metro-North Railroad is committed to providing non-discriminatory service to ensure that no person is excluded from participation in, or denied the benefits of, or subjected to discrimination in the receipt of its services on the basis of race, color, national origin or income as protected by Title VI of the Civil Rights Act of 1964. For more information visit [www.mta.info](http://www.mta.info) or contact:

**MTA Metro-North Railroad**  
Office of Diversity and Equal Employment Opportunity 420 Lexington Avenue, 12th floor, New York, NY 10170, or email us at [MNRDiversityEEO@mnro.org](mailto:MNRDiversityEEO@mnro.org), or call 511 (say Metro-North; ask for the Employee Directory in the More Options menu).

Complaints may also be directed to:  
**U.S. Department of Transportation Federal Transit Administration**  
 Office of Civil Rights, Attn: Complaint Team,  
 East building 5th Floor - TCR, 1200 New Jersey Ave. SE,  
 Washington, DC 20590

