



West 28th Street Substation Project

Construction Look Ahead for the week of May 29, 2023

Helpful Links

[Project Website](#)



Project Website

[Project Details](#)

[West 28 St Substation FAQ](#)

[VIDEO: Core Infrastructure - Substations](#)

[VIDEO: What is CBTC?](#)

[About CBTC upgrades](#)

[Other MTA Projects](#)

[MTA.info](#)



You are receiving this notice as part of the MTA's continuing effort to keep the community apprised of construction activities in support of the West 28th Street Substation project.

The MTA's contractor for the W28th Street Substation Project, Skanska E-J Electric 28S Joint Venture, completed the following items this week:

Main work zone – Secant pile installation, concrete placement, rock socket drilling, overburden drilling, excavated soil trucked out, and securing the rig, tooling and compressors.

East work zone – MTA duct bank installation related work including trench excavation

Work during the week of May 29th will include, but not be limited to:

- **Main work zone** – Restoration of the south lane segment of roadway
- **East Zone:**
 - Con Edison duct bank alteration
 - NYC Transit Authority duct bank installation

Installing/Rerouting Utility Lines, Secant Piles

Stage 1 – Main work zone shift to north side for stage 2 operations.

Stage 2 – North side work begins week of June 5th.

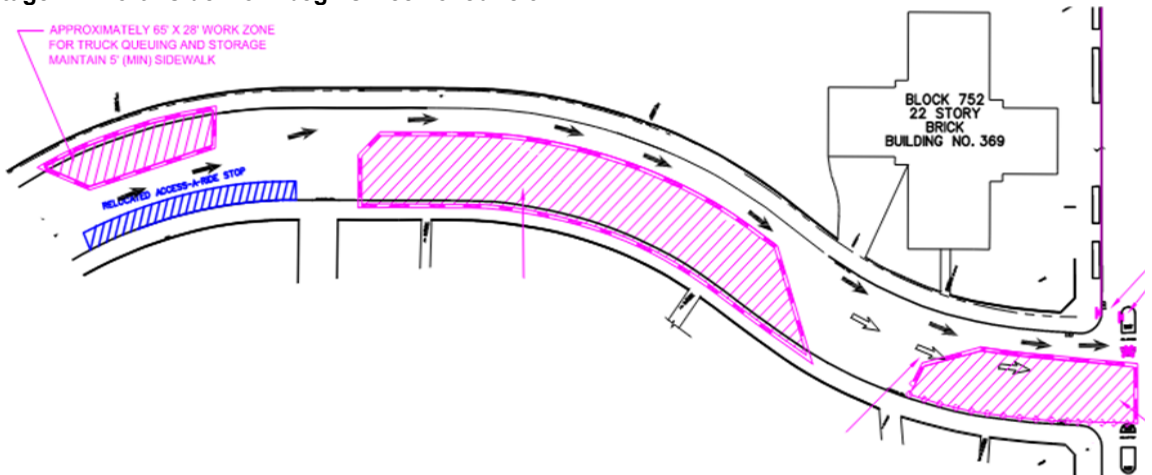

Project Status

Contract Awarded: 10/24/2022

- Contractor: Skanska E-J Electric 28S Joint Venture
- Mobilization: 1/16/2023
- Milestone #1 (restoration of 28 Street): 12/25/2024
- Milestone #2 (Substantial Completion): 9/16/2025
- Final Completion: 12/15/2025

Work hours for the project are 7am to 6pm Monday to Friday, though we anticipate confining the noisiest of work to 8am-4pm.

The contractor is allowed per DOT permit to work 8am-4pm on weekends, but no noisy work is allowed.

The MTA is building a new underground power substation at West 28 Street. This will provide dependable and redundant power for the existing system serving the **A**, **C**, **E** subway lines, while also supporting our upgrade to a new train control system which will bring you better, more frequent, and more reliable service.

The community can expect regular communication, throughout the project, including regular construction updates and at key milestones on the [project's webpage](#) and a dedicated email address (w28thoutreach@mtacd.org) to field concerns.

Thank you for your patience while we build this vital public works project.

